

LEGENDA: LEGENDA:

- | | | | | | | | |
|--|--|--|---|--|--|--|--|
| | 600mm X 600mm COMPOSITION CEILING TILE CONTROSOFFITTO IN PANNELLI FONQASSORBENTI 600mm x 600mm | | PENDANT MOUNTED FLUORESCENT LIGHT FIXTURE CORPO ILLUMINANTE FLUORESCENTE A SOSPENSIONE | | SUPPLY AIR DIFFUSER DIFFUSORE ARIA DI MANDATA | | CEILING MOUNTED PUBLIC ADDRESS SPEAKERS ALTOPARLANI PER TELECOMUNICAZIONI MONTATI A SOFFITO |
| | GYPSUM WALLBOARD, INTERIOR PANNELLO IN CARTONGESSO, INTERNO CEMENT PLASTER, EXTERIOR INTONACO DI CEMENTO, ESTERNO | | SUSPENDED / SURFACE MOUNTED FLUORESCENT LIGHT FIXTURE APPARECCHIO LUCE FLUORESCENTE SOSPESO / A SOFFITTO | | RETURN AIR REGISTER BOCCHETTA DI RIPRESA | | EXHAUST AIR REGISTER BOCCHETTA DI ESPULSIONE |
| | RECESSED LIGHT FIXTURE APPARECCHIO ILLUMINANTE DA INCASSO | | EXIT LIGHT LUCE INDICAZIONE USCITA | | ACCESS DOOR PANNELLO D'ACCESSO | | PENDANT LIGHT FIXTURE APPARECCHIO ILLUMINANTE SOSPESO |
| | FLUORESCENT LIGHT FIXTURE APPARECCHIO ILLUMINANTE FLUORESCENTE | | FIRE ALARM SPEAKER ALTOPARLANTE ALLARME INCENDIO | | SMOKE DETECTOR RIVELATORE DI FUMO | | HEAT DETECTOR RIVELATORE DI CALORE |
| | INDIRECT LIGHT FIXTURE APPARECCHIO ILLUMINANTE INDIRETTO | | | | | | |

NOTE:

NOTE DEL FOGLIO:
1. XXX

NOTE DI RIFERIMENTO:
① XXX

NOTE DEI MATERIALI:

NOTES:

SHEET NOTES:
1. XXX

KEY NOTES:
① OPEN TO STRUCTURE ABOVE

MATERIAL NOTES:



EQUIPMENT LEGEND: XXX LEGENDA:

- A1120, CEILING MOUNTED SURGICAL COLUMN. SEE DETAIL XX/QL-50X
XXX
XXX
- A1120A, CEILING MOUNTED MONITOR CARRIER. SEE DETAIL XX/QL-50X
XXX
XXX
- M7405 AND M7490 CEILING MOUNTED EXAM/SURGICAL LIGHT. SEE DETAIL XX/QL-50X
XXX
XXX
- M7515, RETRACTABLE CEILING MOUNTED LIGHT. SEE DETAIL XX/QL-50X
XXX
XXX
- A5180, CEILING MNTD CUBICAL CURTAIN TRACKS
XXX
XXX
- M0410, RECESSED CEILING MNTD PROJECTION SCREEN. SEE DETAIL XX/QL-50X
XXX
XXX
- M0385A, CEILING PROJECTOR BRACKET. SEE DETAIL XX/QL-50X
XXX
XXX
- A5215A, CEILING MOUNTED TV/DVD/VCR. SEE DETAIL XX/QL-50X
XXX
XXX
- D6100, CEILING MOUNTED DENTAL LIGHT. SEE DETAIL XX/QL-50X
XXX
XXX

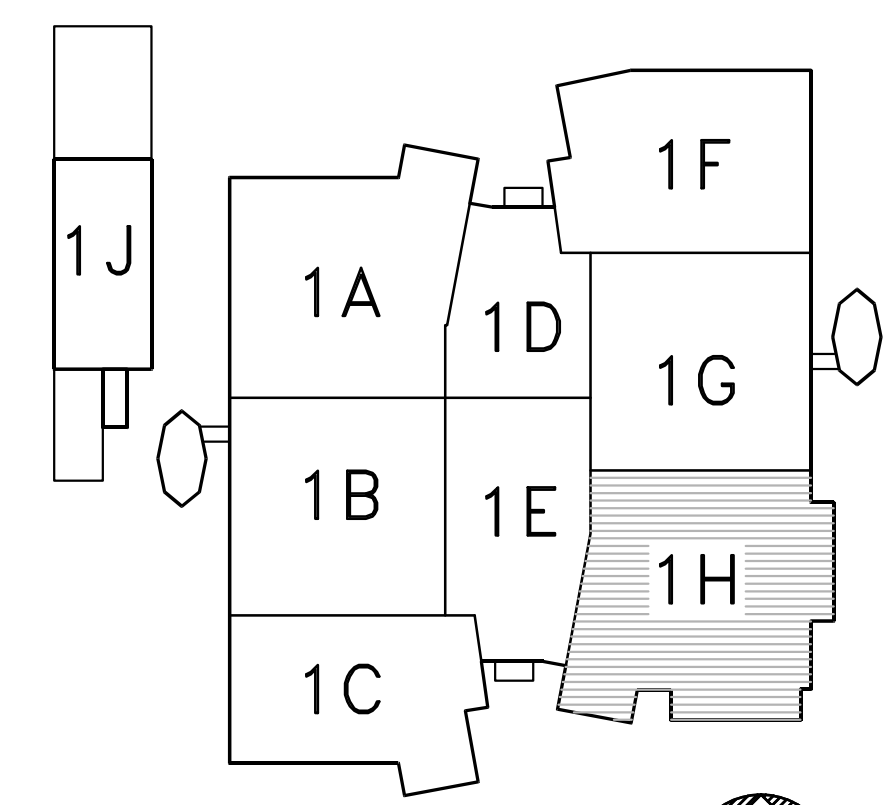

KEY PLAN
ENHANCED HEALTH SERVICE CENTER
PIANTA DI RIFERIMENTO

0 1000 3000 5000 10000
1:100 GRAPHIC SCALE (MILLIMETERS)
SCALA GRAFICA (MILLIMETRI)

NOTE: /NOTA:
IF THIS DRAWING IS LESS THAN 838.2 X 558.8mm IT IS A REDUCED SIZE DRAWING.
SE QUESTO DISEGNO E' PIU' PICCOLO DI 838.2 X 558.8mm E' UN DISEGNO A DIMENSIONI RIDOTTE.

ITALIAN
FIRST FLOOR CEILING PLAN - SECTOR 1H
1:100

| | |
|--|--------------------------------------|
| DATE | APPR |
| DESCRIPTION | SYN |
| RLF Architecture • Engineering • Interior Design | |
| APPROVED | SEAL |
| ACTIVITY - SATISFACTORY TO | |
| APPROVED | |
| FOR EFD FOR COMMANDER NAVFAC | |
| DATE | |
| A/E | EFD |
| DESIGN | |
| DRAWN | |
| REVIEW | |
| QC | |
| RWL | CHIEF ARCH/ ENGR. |
| PROJECT MANAGER | |
| FIRE PROTECTION | |
| BRANCH MANAGER | |
| DESIGN DIRECTOR | |
| DEPARTMENT OF THE NAVY | NAVAL FACILITIES ENGINEERING COMMAND |
| NAVAL STATION | ATLANTIC DIVISION |
| CAMP EDERLE | VICENZA, ITALY |
| ENHANCED HEALTH SERVICE CENTER | |
| FIRST FLOOR CEILING PLAN - SECTOR 1H | |
| CODE ID. NO. 80091 | SIZE D |
| EFD NO. | SCALE: 1:100 |
| STA. PROJ. NO. 2455 | |
| SPEC. NO. 33050801 | |
| CONSTR. CONTR. NO. N33191-05-R-0801 | |
| NAVFAC DRAWING NO. | |
| SHEET ### OF ##### | |
| AE111H | |
| DRAWFORM REVISION SEPT 2001 | |